





Let's ride.

Halfway between yeehaw and hell yeah you can find The Far Out Lounge - the biggest outdoor venue in Austin, TX.

We opened in 2019, with roots stretching back to 1908. Originally known as "The Last Chance Bar," hosting the likes of Willie Nelson, Janis Joplin, and the bank-robbing Newton Boys for their post-heist brews.

Honoring our past and forging the funky future of South Austin, we offer cold drinks, good food, live music and whatever kind of event your heart desires. Voted Best New Venue at the Austin Music Awards 2020. Winner in the Austin Chronicle "Best of Austin" Critic's Poll 2019.



STAGES

Stage 1: Permanent
Downstage Length 19'
Upstage Length 14'
Stage Depth 14'8"

Stage 2: Modular tent stage
Downstage Length: 16'
Upstage Length: 20'
Height: 3'

CAPACITY

2,000*

PARKING

On-site parking available, 150 spots

BARS

1 outdoor bar and 1 indoor bar

FOOD TRUCKS

Fowl Mouth
Austin Rotisserie
Lucky's Italian Sandwiches
Los Danzantes
Garbo's

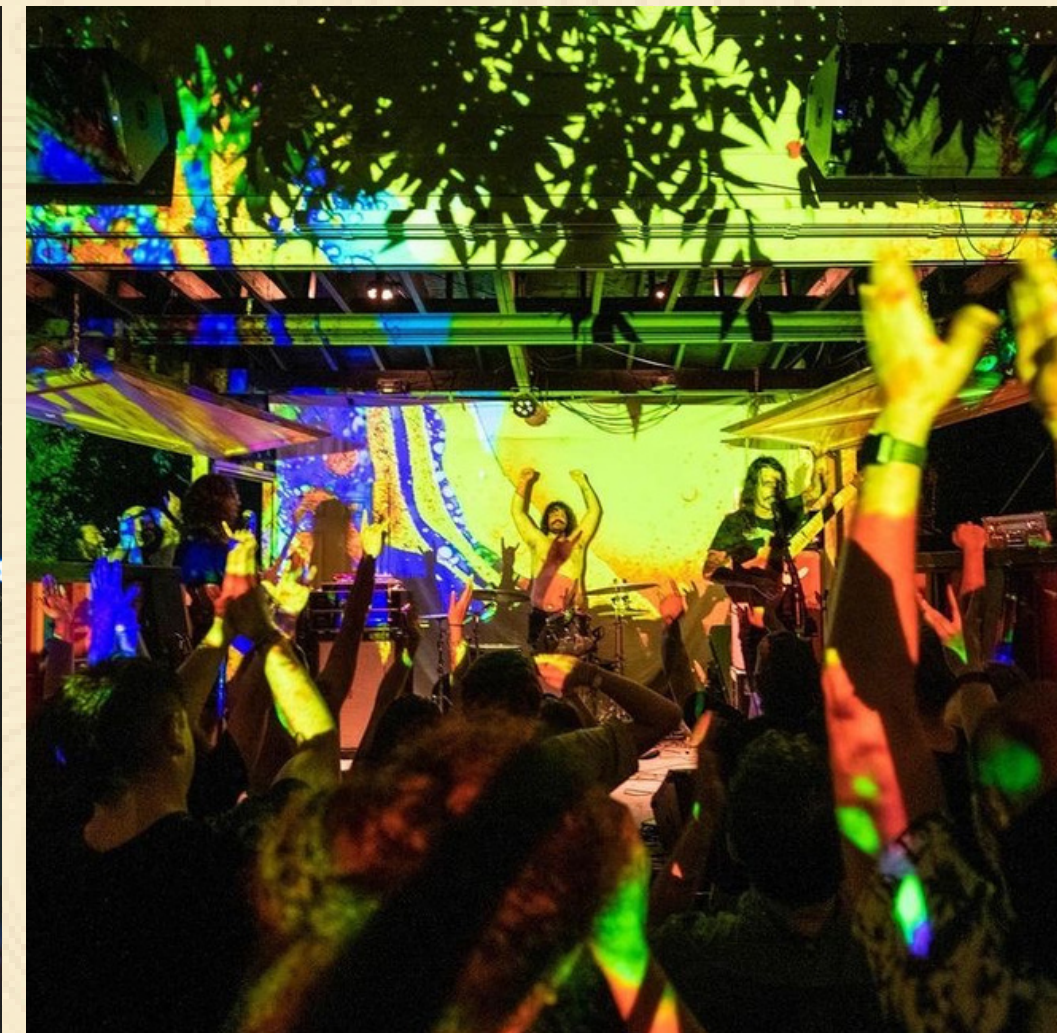



Amenities & Gear

We have a decked out green room for artist hospitality with F&B. Arrangements can change based on contract.

Below is a list of gear we have immediately available on-site. Looking for something not listed here? We can source it - just holler.

MICROPHONES

- 10 Shure SM58 vocal mic
- 3 Shure SM57 instrument mic
- 2 Audix i5 instrument mic
- 2 Shure pga8 condenser mic
- 2 Sennheiser e614 condenser mic 2
- Audio Technica AT2021 condenser
- 1 Audix D6 kick drum mic
- 1 Sennheiser e902 kick drum mic
- 3 Sennheiser e609 guitar mic
- 5 Sennheiser e604 drum mic

DI BOXES

- 1 Radial pro D2
- 10 Rapco Horizon DB1

LIGHTING

Basic LED stage lighting DMX controlled from FOH w/ programmable scenes

MIXING CONSOLE

- Behringer X32
- 32 channel mixing console
- 5 monitor mixes from FOH
- Stereo Mains
- Stereo LR w/ center fill
- Mono Subs on Aux

MAINS

- 2 QSC KW 153 (1000w 3 way speaker)
- EV ETX 35p x 2
- 15 inch LF SMX woofer
- 6.5 inch MF driver
- 1.25 inch HF titanium compression driver
- 2000 W class D-power amplifier with integrated FIR-Drive DSP
- 136 dB peak SPL

SUBS

- 2 JBL SRX828SP (2000w dual 18" speakers)
- EV ETX 18sp x 4
- 18 inch DVX woofer for extended low frequency response
- 1800 W Class-D power amplifier with integrated FIR-Drive DSP
- 135 dB peak SPL

MONITORS

- 1 QSC KW 122 (1000w 2 way speaker)
- 4 EV ELX 112P (1000w 2 way speaker)



[Click here for more visuals](#)



- legend
- 1/2" REBAR FOUND
 - 1/2" CAPPED REBAR SET
 - 1/2" IRON PIPE FOUND
 - 600 NAIL FOUND
 - 600 NAIL SET
 - CAPPED REBAR FOUND
 - "X" SET IN CONCRETE
 - "X" FOUND IN CONCRETE
 - CALCULATED FROM RECORD DATA
 - PUNCH HOLE FOUND
 - CHAIN LINK FENCE
 - WOOD FENCE
 - METAL FENCE
 - B.L. BUILDING LINE
 - P.U.E. PUBLIC UTILITY EASEMENT
 - D.E. DRAINAGE EASEMENT
 - F.F.E. FINISHED FLOOR ELEVATION
 - () PER PLAT
 - C.M. CONTROL MONUMENT
 - R.O.W. RIGHT OF WAY
 - P.O.B. PLACE OF BEGINNING
 - OVERHEAD UTILITY LINE
 - POWER POLE
 - AIR CONDITIONER

exit door schedule		
Door #	Width	"
①	1	48
②	2	48
③	3	48
④	4	58
⑤	5	60
⑥	6	60
⑦	7	48
⑧	8	48
total inches		418"

event tents, typ.
25 total tents

existing storage

waste receptacle

recycling receptacle

compost receptacle

LOT 3

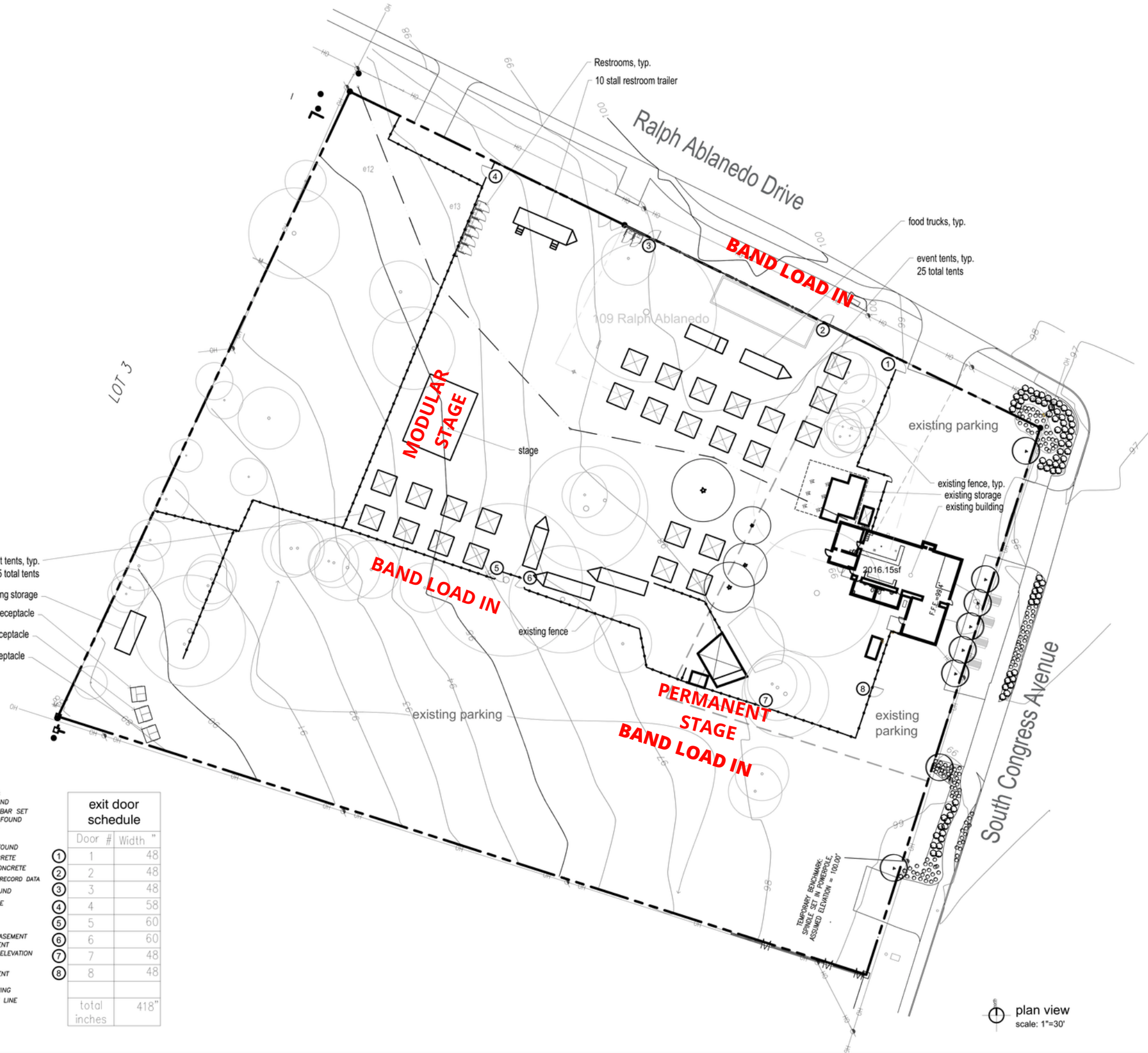

plan view
scale: 1"=30'



BREAUX DESIGN GROUP
landscape architecture + construction
512.418.6164
www.breauxdesign.com



The Far Out Lounge & Stage
8504 South Congress Avenue
Austin, Texas 78745

Not for regulatory approval, permitting, or construction.
Stephen Breaux, Landscape Architect



sheet key

sheet name

ACE PERMIT SEPTEMBER

project number
191108

date
07.20.2021

drawn by
slb

checked by
-

sheet number

LP-1



Contact



Booking: Lawrence@thefaroutaustin.com

Media: Allison@thefaroutaustin.com

[8504 Congress Ave. Austin, TX 78745](#) | (512) 351-9909



[@thefaroutaustin](#)



[@thefaroutlounge](#)



thefaroutaustin.com